

Tong Wang
The Last Kingdom

Very early morning

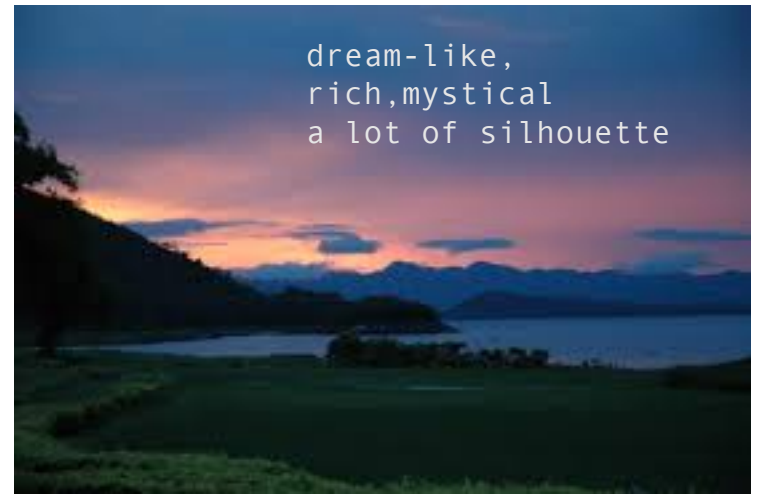

dream-like,
rich, mystical
a lot of silhouette

cyc streak of
cloud texture
sunrise
Leko
h70, v0
R51 or R336



silhouette
cool, crisp
Straight Backs
Par 64
h0, v60
L200

gentle sunrise
shin
Leko
h90, v-10
R51

special down
mover
h0, v0
arch source
white

stream of water
special
mover
h90, v65

Blue with
animated gobo

cool, crawling
crispness of
night
PEL
Leko
h90, v35
L711 o L600

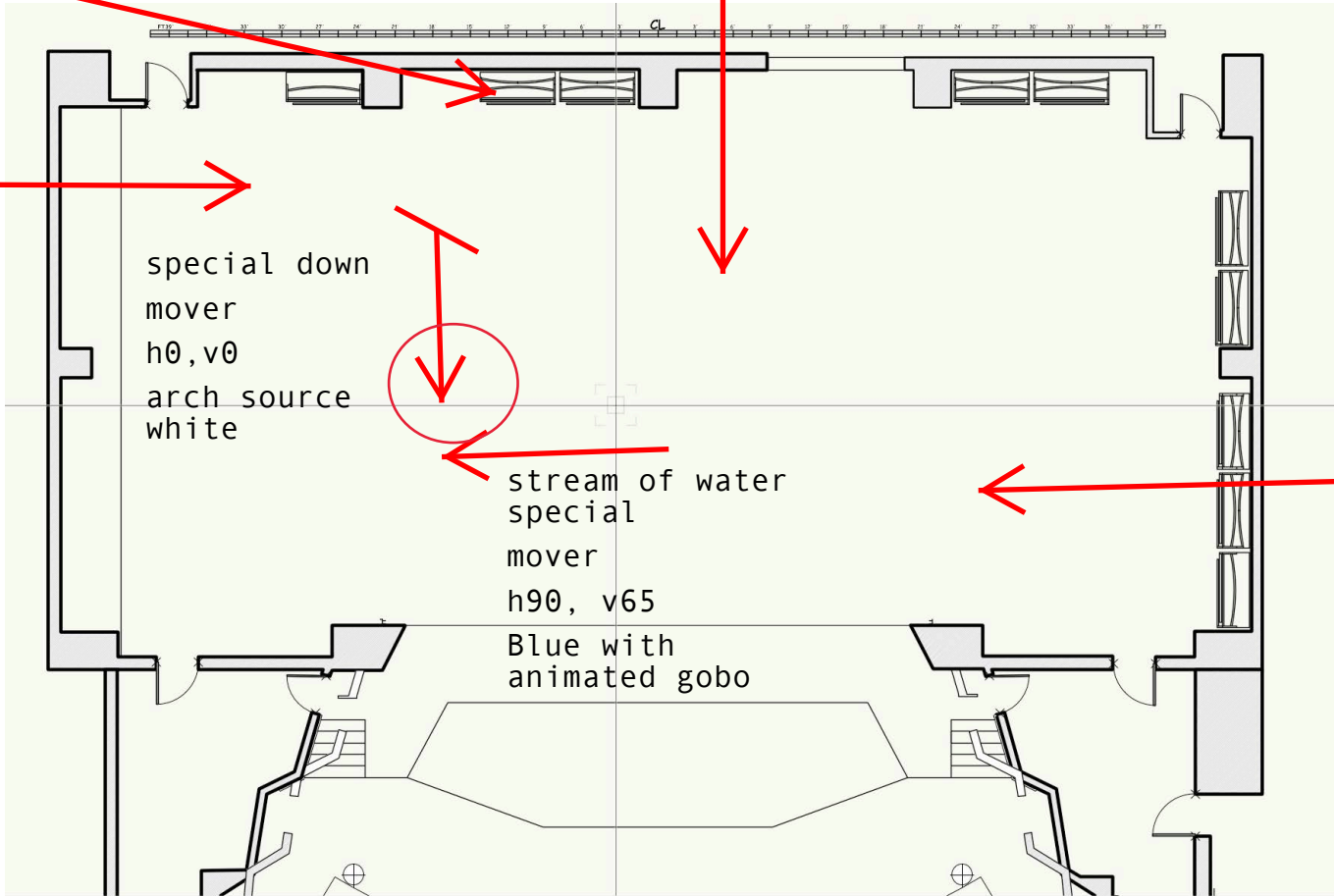

cyc streak of
cloud texture
sunrise
Leko
h70, v0
R303 or R30

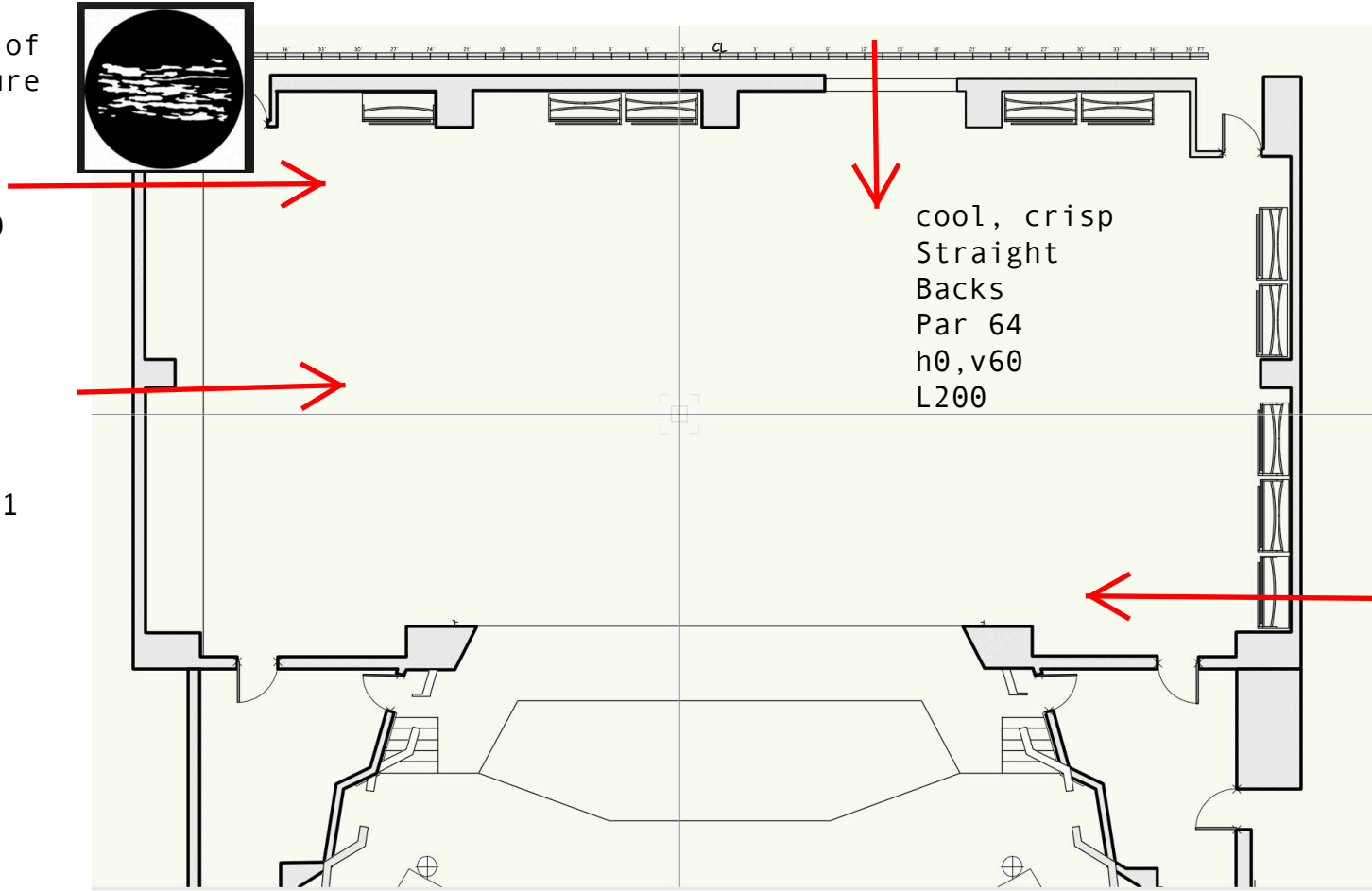

sweeping sunrise
PER
Leko
h90, v35
L506 or R3408/3411

cool, crisp
Straight
Backs
Par 64
h0, v60
L200

form floating
shin
Leko
h90, v-10
L201

early morning

Tong Wang
The Last Kingdom



sensual, flirty, elusive
continued play with
silhouette

Tong Wang
The Last Kingdom

midday



bold, strong, bright, energetic, crisp



cool, crisp
Straight Backs
Par 64
h0,v60
L200

fresh mountain
air
PER
Leko
h90,v35
L362

lifting cool
shin
Leko
h90,v-10
L201

Angle Wash Left
Leko
h0,v45
R54

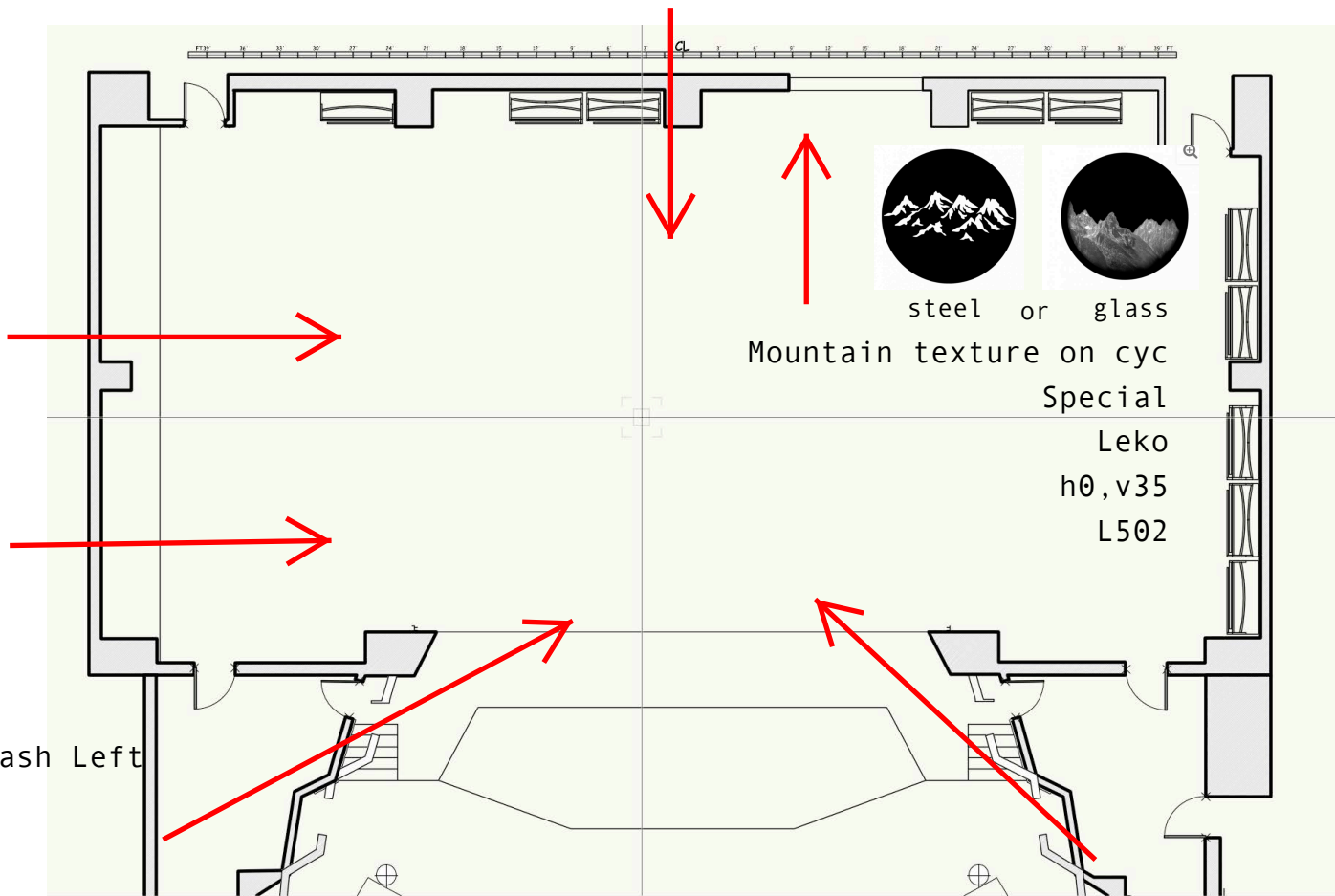

steel or glass
Mountain texture on cyc
Special

Leko
h0,v35
L502

warm blue
visibility
Front Wash
h0,v45
L501

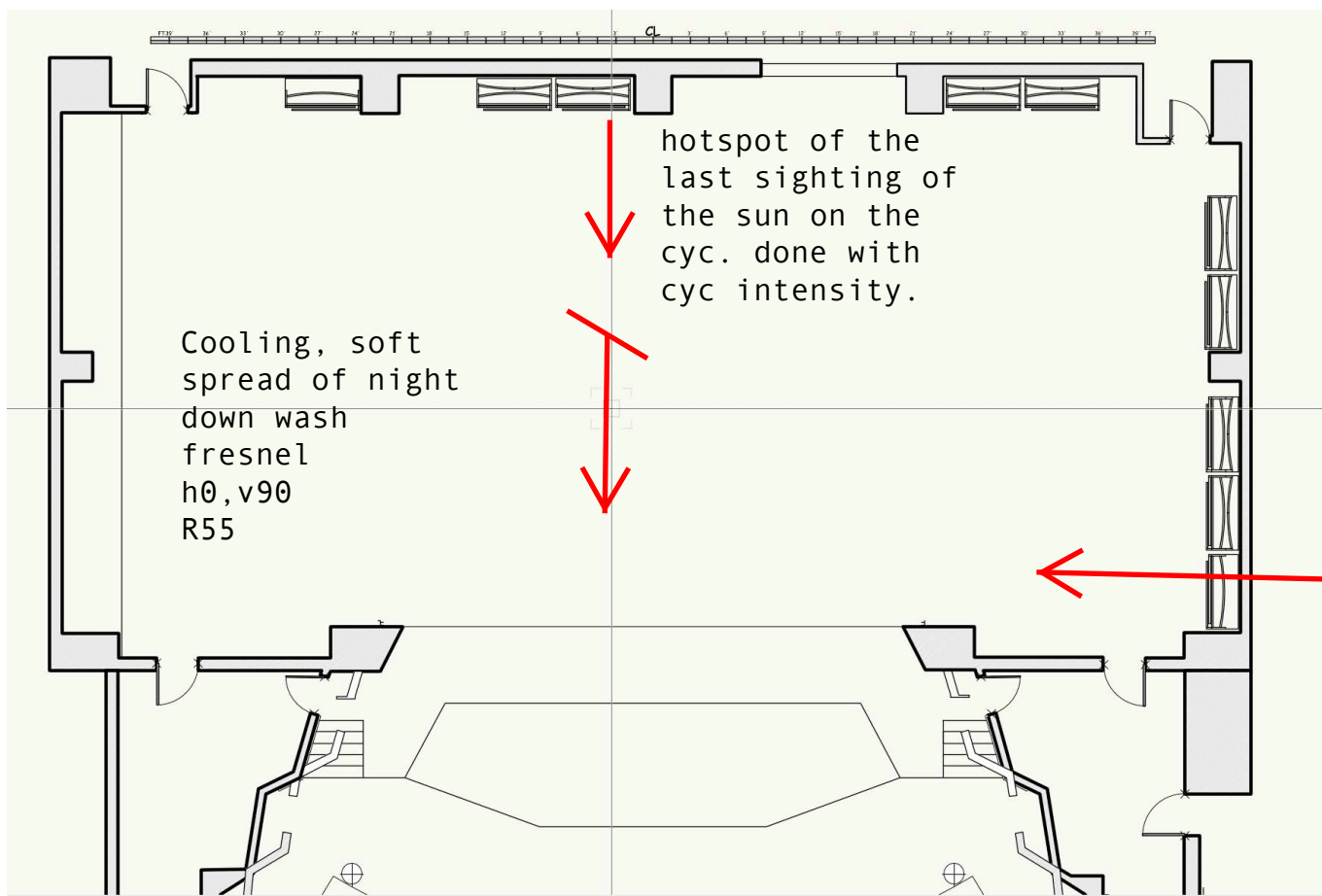

bold punch of fading sun light
 Heads
 Par 64
 h90,v0
 L019

sunset

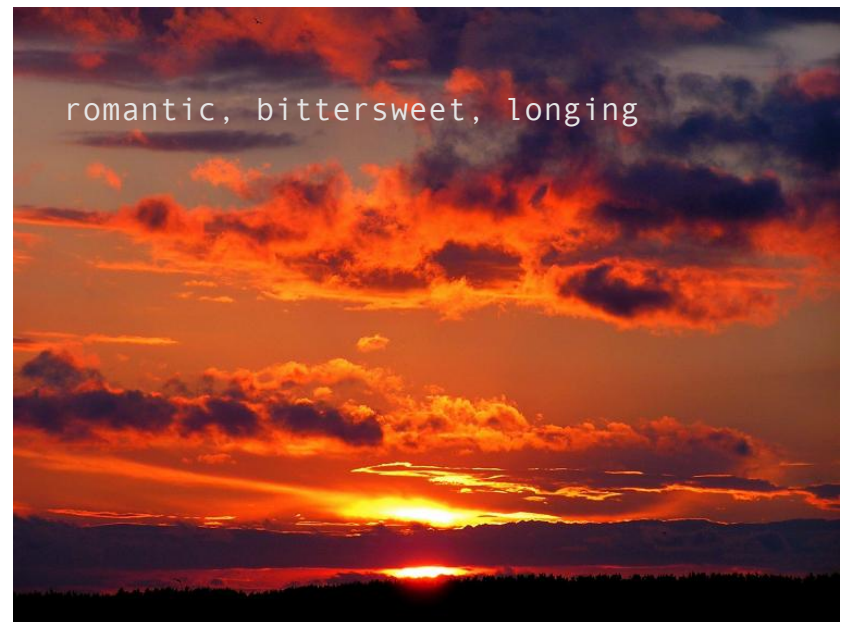

Tong Wang
The Last Kingdom

Tong Wang
The Last Kingdom

moonlit night

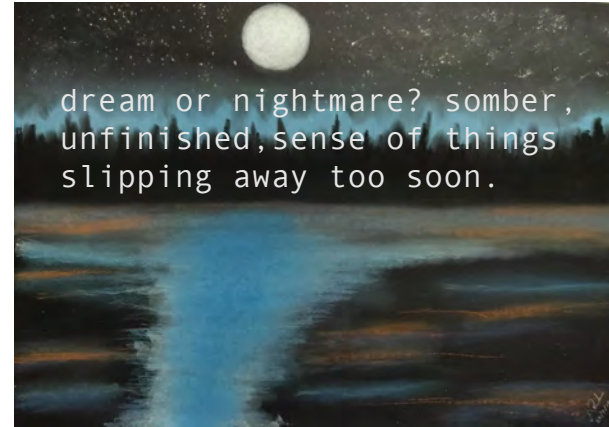

single moon
source.
silhouetting
and ominous
wrapping
Fresnel 5k
h45, v45
L600 (color
possible?)

